

TeraStation WSS

Buffalo TeraStation™ WSS 5000 2 Bay with Windows® Storage Server 2012 R2

BUFFALO™

WS5200DNW2

TeraStation™ WS5200DNW2 brings you the power of Windows® Server OS and Intel® Atom™ Dual-Core Processor in a 2-bay form factor. The TeraStation™ WS5200DNW2 is powered by the Microsoft Windows® Storage Server 2012 R2 Workgroup Edition, providing seamless integration with all Windows® computers and servers.

■ Hard drives designed for NAS systems

Especially designed for use in NAS systems, the TeraStation's hard drives feature highly new technologies for highly reliable and stable operation. The drives are also equipped with specialized NAS firmware designed specifically for the extended operation that NAS devices are famous for.

Features

- Reduced power consumption and operating temperatures
- Vibration and noise suppression
- Stable operation and lower operating costs

■ Expand your existing server's storage capacity with iSCSI

The TeraStation™ WSS 5000 R2 Series can be used as an iSCSI storage array, allowing you to expand the storage space of your existing server. Since this can be done through the LAN network, installation location can be flexible.

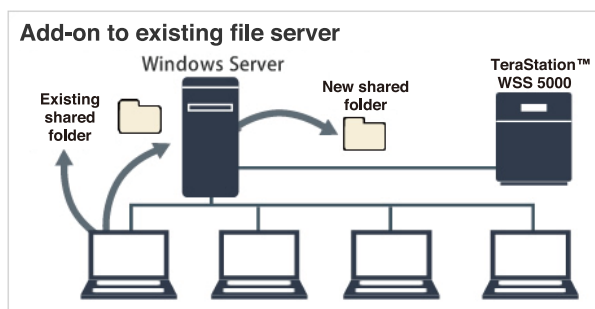

■ Provides 3 years warranty

Buffalo's original corporate model quality standard requires selection of highly reliable parts and strict product development, pursuing for product's durability and longevity. As a result, Buffalo is able to provide 3 years warranty on this TeraStation™ WSS 5000 R2 Series.

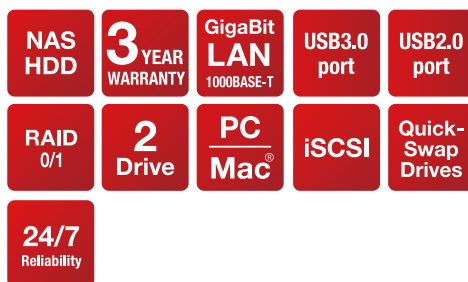
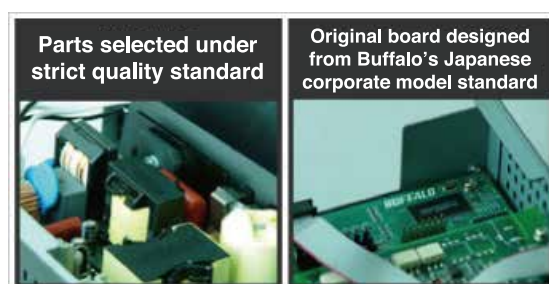

Features

- Dual Core Intel® Atom™ Processor D2700 1.86GHz
- Hard drives designed for NAS systems
- Windows® Storage Server 2012 R2 Workgroup Edition
- iSCSI Target and Initiator
- Front loading hot swap hard drives with lockable front panel
- Active Directory support
- Disk quota (soft quota) support prevents users/groups from consuming too much disk space
- Scheduled shut down eliminates unnecessary access and reduces energy costs
- DFS (Distributed File System), Namespace & Replication support
- 10/100/1000 Mbps Gigabit Ethernet with Jumbo Frame
- 2 Ethernet ports for port trunking
- Works with VMware and Hyper-V (SAN Storage for Virtual Machines)
- Supported RAID levels: JBOD, RAID 0/1
- Large quiet fan cools hard drive efficiently
- LCD Display shows important TeraStation information and disk status
- 2 USB 3.0 ports and 2 USB 2.0 ports for external drive, printer and UPS connectivity
- 3 years limited warranty

WS5200DNW2

Specifications

Hardware

CPU	Dual Core Intel® Atom™ Processor D2700 1.86GHz
RAM	4GB DDR3

Software

OS	Windows® Storage Server 2012 R2 Workgroup Edition
Connection Limit	50

Internal Hard Drives

Drive Interface	SATA(II) 3Gbps
Number of Bays	6
Hard Drive Capacities	2TB, 4TB
Total Capacities	4TB, 8TB
Supported RAID Levels	JBOD, RAID 0/1

LAN Interface

Standard Compliance	IEEE 802.3ab/IEEE 802.3u/IEEE 802.3
Link Speed	10/100/1000 Mbps with Jumbo Frame
Connector Type	RJ-45
Number of LAN Ports	2

USB Interface

Standard Compliance	USB 3.0/2.0
Number of Ports	2 x USB 3.0/2 x USB 2.0
Data Transfer Rate	5Gbps USB 3.0/480Mbps USB 2.0 (theoretical value)

Serial Port

Connector Type	D-SUB 9pin
Number of Ports	1

Protocol Support

Networking	TCP/IP
File Sharing	CIFS/SMB, FTP/SFTP/FTPS, NFS
Directory Integration	LDAP, Active Directory
Management	Remote Desktop Protocol (RDP), Terminal Services Client
Time Synchronization	NTP

Others

Dimensions (W x H x D)	170 x 170 x 230mm
Weight	4kg
Power Supply	Internal, AC 100-240V 50/60Hz
Power Consumption	Max. 47W
Operating Environment	Temperature: 5 - 35°C, Humidity: 20 - 80% (non-condensing)
Supported Client OS	Windows® 8.1/8 (32/64bit), Windows® 7 (32/64bit), Windows Vista™ (32/64bit), Windows® XP, Windows Server® 2012 R2/2012/2008 R2/2008/2003 R2/2003, Mac OS® X 10.5 and above

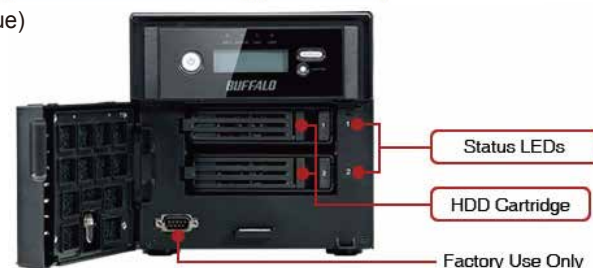
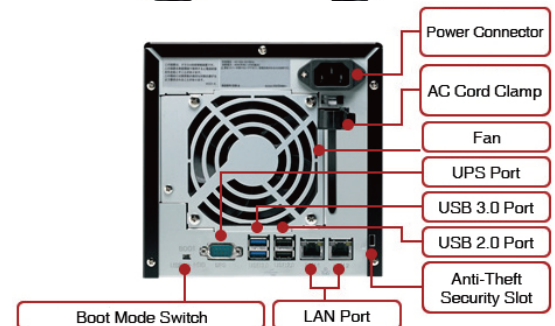
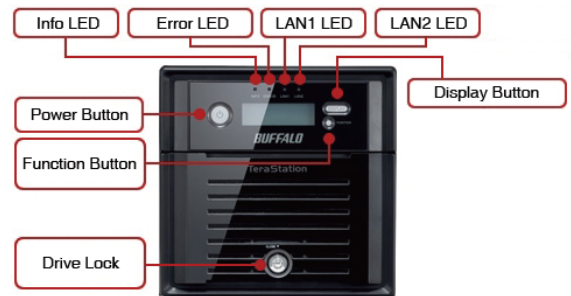

About BUFFALO

www.buffalo-asia.com

BUFFALO Inc., based in Nagoya, Japan, is a leading global provider of award-winning networking, storage and multi-media solutions for the home and small business environments as well as for system builders and integrators. With three decades of networking and computer peripheral experience, BUFFALO has proven its commitment to delivering innovative, best-of-breed solutions that have put the company at the forefront of infrastructure technology.