

WCR-G300

Easy setup, access the Web from your smartphone a snap

■ Easy setup without CD

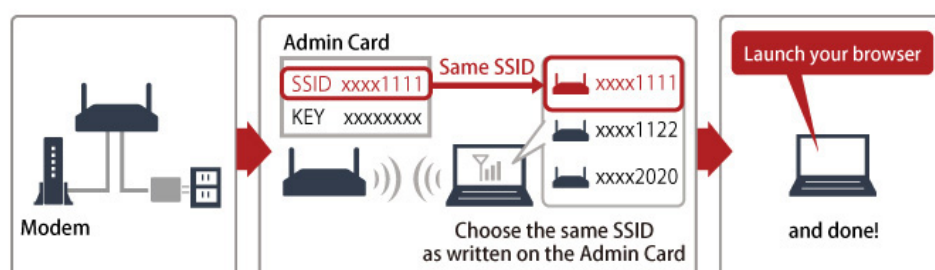

Setting up the router is simple and quick with the web-based setup wizard. First, connect your router and modem, then plug in the router to the AC adapter to turn it on. Secondly, search for the available LAN connection on the network from your computer. Choose the same SSID as written on the Admin Card. Third, launch your web browser and setting screen appears. Set the operation condition as needed to complete the setup. (some environments may require PPPoE settings). It's that simple!

■ Adjustable antennas reduce dead spots

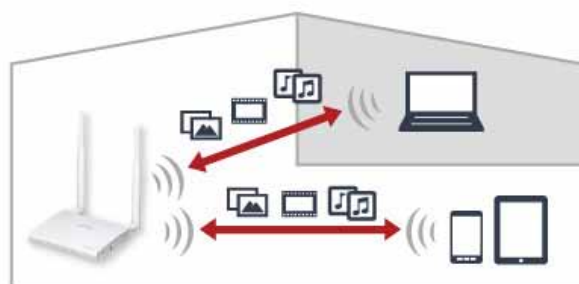

The double 5dBi adjustable antennas and 11n standard combine to simultaneously transmit dual data streams for improved performance and higher data transfer rates of up to 300 Mbps*, providing faster, more reliable delivery of streaming video and other digital content. This also improves range by allowing the signal to bypass obstacles, helping to reduce dead spots that block wireless transmission in your home. This also makes the router the optimal way to link your smartphone to your home network. Enjoy trouble-free streaming of video and music.

■ Wireless Distribution System (WDS) extends your wireless network across access points

The Wireless Distribution System (WDS) further expands wireless coverage with other BUFFALO routers supporting WDS, reducing or even eliminating dead spots that hinder and may even prevent network functioning and Internet access. This is important in home and office environments where interior walls, corners, and other obstructions reduce or block signals from less powerful conventional routers.



BCN AWARD 2011

Features

- Improved, easier setup—simple and quick with the web-based setup wizard
- 802.11n standard for higher data transfer rates up to 300 Mbps*
- Double 5 dBi adjustable antenna—fine-tune the antenna positioning to eliminate dead spots
- Backward compatible with 1 x 1, 802.11g/b devices
- High-spec Ralink 400MHz CPU
- Wireless Distribution System (WDS) extend your wireless network across access points

- Easy setup with AirStation One-Touch Secure System (AOSS™)
- Easy wireless network configuration with application for Android smartphones, AOSS for Android
- Multi-level Wireless Security Support: WPA2-PSK (TKIP, AES), WPA-PSK (TKIP, AES), and WEP (128/64-bit)
- Eco Minded - Energy saving feature reduces power consumption by 28%**
- Allows up to 4 simultaneous wired connections
- Compact chassis
- 3-Year Warranty

WCR-G300

Specifications

Model

WCR-G300

Wireless LAN Interface

Standard Compliance	IEEE802.11n/g/b
Transmission Method	Direct Sequence Spread Spectrum (DSSS), OFDM, MIMO
Transmission Rate	IEEE802.11n: Max 300 Mbps IEEE802.11g: Max. 54 Mbps IEEE802.11b: Max. 11 Mbps
Security	WPA2-PSK(AES,TKIP), WPA-PSK(AES,TKIP), 128/64bit WEP
Antenna	2 x 5 dBi antennas

Wired LAN Internet

Standard Compliance	IEEE802.3/3u
Speed and Flow Control	100/10 Mbps (Auto-Sensing)
Number of WAN Ports	4
Connector Type	RJ-45 (Auto MDIX)

WAN Interface

Transmission Rate	100/10 Mbps (Auto-Sensing)
Number of WAN Ports	1
Connector Type	RJ-45 (Auto MDIX)
WAN Security	Dynamic Packet Filtering, Intrusion Detector, NAT/SPI Firewall

Others

OS Support	Windows				Mac OS X
	7 (64-bit/ 32-bit)	Vista (64-bit/ 32-bit)	XP (Include MCE)	2000	10.7 10.6 10.5 10.4
	✓	✓	✓	✓	✓
Dimensions (WxHxD)	120 x 105 x 22 mm (Exclude antennas)				
Net Weight	176 g				
Operating environment	0 - 40°C, 20 - 80% RH (Non-condensing)				
Power consumption	Max. 4.0W				
Power supply	AC 100-240V, 50/60 Hz				
Warranty	3-Year				

Wired LAN Internet

- AirStation N300 Wireless-N Router & Extender WCR-G300
- Quick Setup Guide
- Ethernet Cable
- AC Adapter
- Admin Card
- Warranty Statement

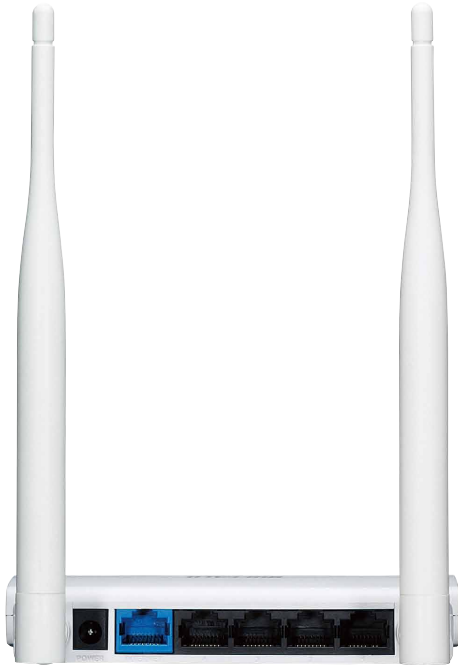

*300 Mbps is the maximum wireless signal rate achievable using two streams of 150 Mbps each. Actual data throughput and range will vary depending upon network conditions and environmental factors, including volume of network traffic, building materials and construction, and network overhead. Maximum speed and range is achievable when used with same enhanced mode technology.

** Testing conducted by BUFFALO in February 2012 <Devices> Wattmeter: YOKOGAWA WT210 Data Quality Analyzer: Netcom Systems Ethernet Switch Tester SMB-2000 <Measurement method>Connect all ports to data analyzer, then transfer broadcast packet from data quality analyzer to wired LAN port, and the power consumption was measured after data transfer was started.

About BUFFALO

BUFFALO Inc., based in Nagoya, Japan, is a leading global provider of award-winning networking, storage and multi-media solutions for the home and small business environments as well as for system builders and integrators. With three decades of networking and computer peripheral experience, BUFFALO has proven its commitment to delivering innovative, best-of-breed solutions that have put the company at the forefront of infrastructure technology.

www.buffalo-asia.com