

# TeraStation WSS

Buffalo TeraStation™ WSS 5000 2 Bay with Windows® Storage Server 2012

# BUFFALO™

## WS5200D

TeraStation™ WS5200D brings you the power of Windows® Server OS and Intel® Atom™ Dual-Core Processor in a 2-bay form factor. The TeraStation™ WS5200D is powered by the Microsoft Windows® Storage Server 2012 Workgroup Edition, providing seamless integration with all Windows® computers and servers.

### ■ Intel® Atom™ Dual-Core Processor & DDR3 memory

The TeraStation™ WSS 5000 Series is equipped with Intel® Atom™ Dual-Core Processor, 4GB DDR3 memory, and USB 3.0, maximizing the data transfer speed to support large data transfers and multiple data transfers which occurs constantly in daily business operations.

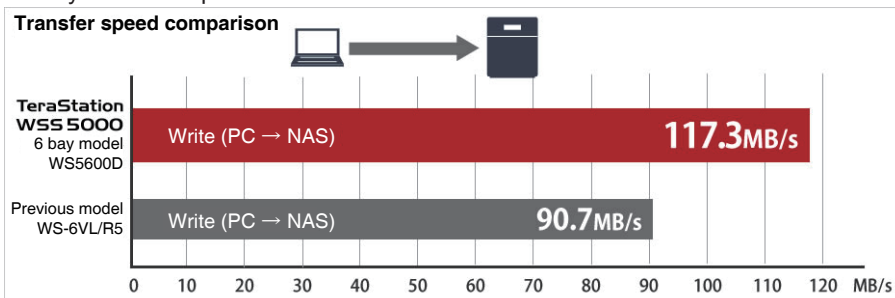

### ■ Expand your existing server's storage capacity with iSCSI

The TeraStation™ WSS 5000 Series can be used as an iSCSI storage array, allowing you to expand the storage space of your existing server. Since this can be done through the LAN network, installation location can be flexible.

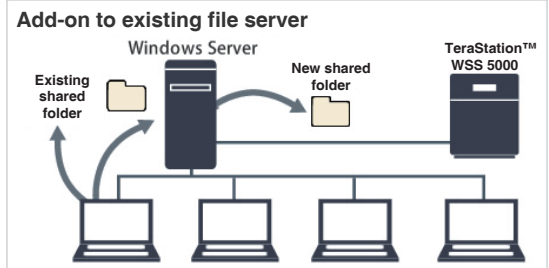

### ■ Provides 3 years warranty

Buffalo's original corporate model quality standard requires selection of highly reliable parts and strict product development, pursuing for product's durability and longevity. As a result, Buffalo is able to provide 3 years warranty on this TeraStation™ WSS 5000 Series.

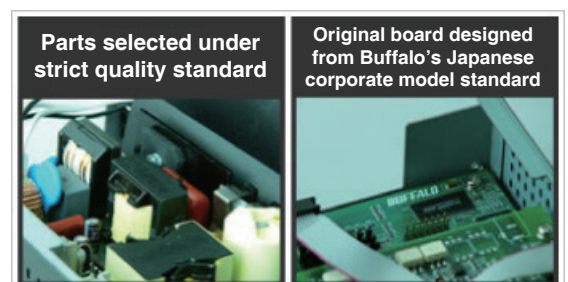

## Features

- Dual Core Intel® Atom™ Processor D2550 1.86GHz
- Windows® Storage Server 2012 Workgroup Edition
- iSCSI Target and Initiator
- Front loading hot swap hard drives with lockable front panel
- Active Directory support
- Disk quota (soft quota) support prevents users/groups from consuming too much disk space
- Scheduled shut down eliminates unnecessary access and reduces energy costs
- DFS (Distributed File System), Namespace & Replication support
- 10/100/1000 Mbps Gigabit Ethernet with Jumbo Frame
- 2 Ethernet ports for port trunking
- Works with VMware and Hyper-V (SAN Storage for Virtual Machines)
- Supported RAID levels: JBOD, RAID 0/1
- Large quiet fan cools hard drive efficiently
- LCD Display shows important TeraStation information and disk status
- 2 USB 3.0 ports and 2 USB 2.0 ports for external drive, printer and UPS connectivity
- 3 years limited warranty

# WS5200D

## Specifications

### Hardware

CPU	Dual Core Intel® Atom™ Processor D2550 1.86GHz
RAM	4GB DDR3

### Software

OS	Windows® Storage Server 2012 Workgroup Edition
Connection Limit	Up to 50 connections

### Internal Hard Drives

Drive Interface	SATA(II) 3Gbps
Number of Bays	2
Hard Drive Capacities	2TB, 4TB
Total Capacities	4TB, 8TB
Supported RAID Levels	JBOD, RAID 0/1

### LAN Interface

Standard Compliance	IEEE 802.3ab/IEEE 802.3u/IEEE 802.3
Link Speed	10/100/1000 Mbps with Jumbo Frame
Connector Type	RJ-45
Number of LAN Ports	2

### USB Interface

Standard Compliance	USB 3.0/2.0
Number of Ports	2 x USB 3.0/2 x USB 2.0
Data Transfer Rate	5Gbps USB 3.0/480Mbps USB 2.0 (theoretical value)

### Serial Port

Connector Type	D-SUB 9pin
Number of Ports	1

### Protocol Support

Networking	TCP/IP
File Sharing	CIFS/SMB, FTP/SFTP/FTPS, NFS
Directory Integration	LDAP, Active Directory
Management	Remote Desktop Protocol (RDP), Terminal Services Client
Time Synchronization	NTP

### Others

Dimensions (W x H x D )	170 x 170 x 230mm
Weight	4kg
Power Supply	Internal, AC 100-240V 50/60Hz
Power Consumption	Max. 47W
Operating Environment	Temperature: 5 - 35°C, Humidity: 20 - 80% (non-condensing)
Supported Client OS	Windows® 8 (32/64bit), Windows® 7 (32/64bit), Windows Vista™ (32/64bit), Windows® XP, Windows Server® 2008, Windows Server® 2003, Windows® 2000 Server, Mac OS® X 10.4 and above

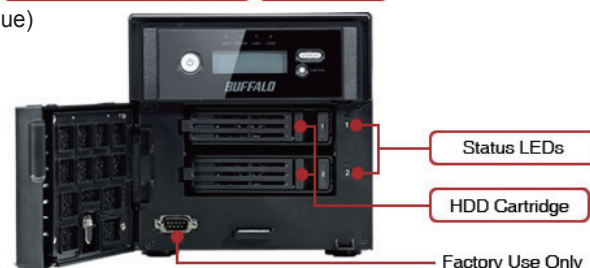
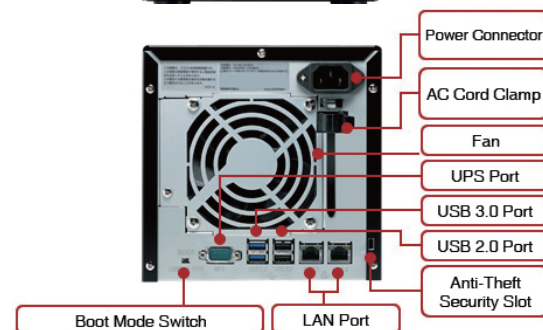
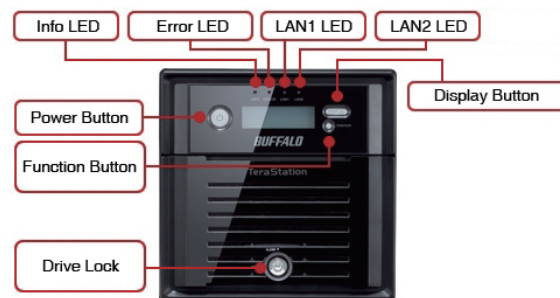

### About BUFFALO

[www.buffalo-asia.com](http://www.buffalo-asia.com)

BUFFALO Inc., based in Nagoya, Japan, is a leading global provider of award-winning networking, storage and multi-media solutions for the home and small business environments as well as for system builders and integrators. With three decades of networking and computer peripheral experience, BUFFALO has proven its commitment to delivering innovative, best-of-breed solutions that have put the company at the forefront of infrastructure technology.